

Klaipėda State Seaport South Gate Complex, Kairiai str. 17, Klaipėda, construction project

STATINIO PROJEKTO PAVADINIMAS (PAGAL SUTARTĮ)

DESIGN TITLE	Klaipėda State Seaport South Gate Complex, Kairiai str. 17, Klaipėda, construction project
DESIGN NUMBER	8858
CLIENT (BUILDER)	AB Klaipėda State Seaport Authority J. Janonio str. 24, 92251 Klaipėda
TYPE OF CONSTRUCTION	New construction
PURPOSE OF THE STRUCTURE	Transport communications: structures of water ports
BUILDING CATEGORY	Non-exceptional structures
DESIGN STAGE	Technical project
DESIGN PART	General part. Drawings
FILE MARK	8858-XX-TP-BD-01.02
REVISION	0
FILE RELEASE DATE	2024-03





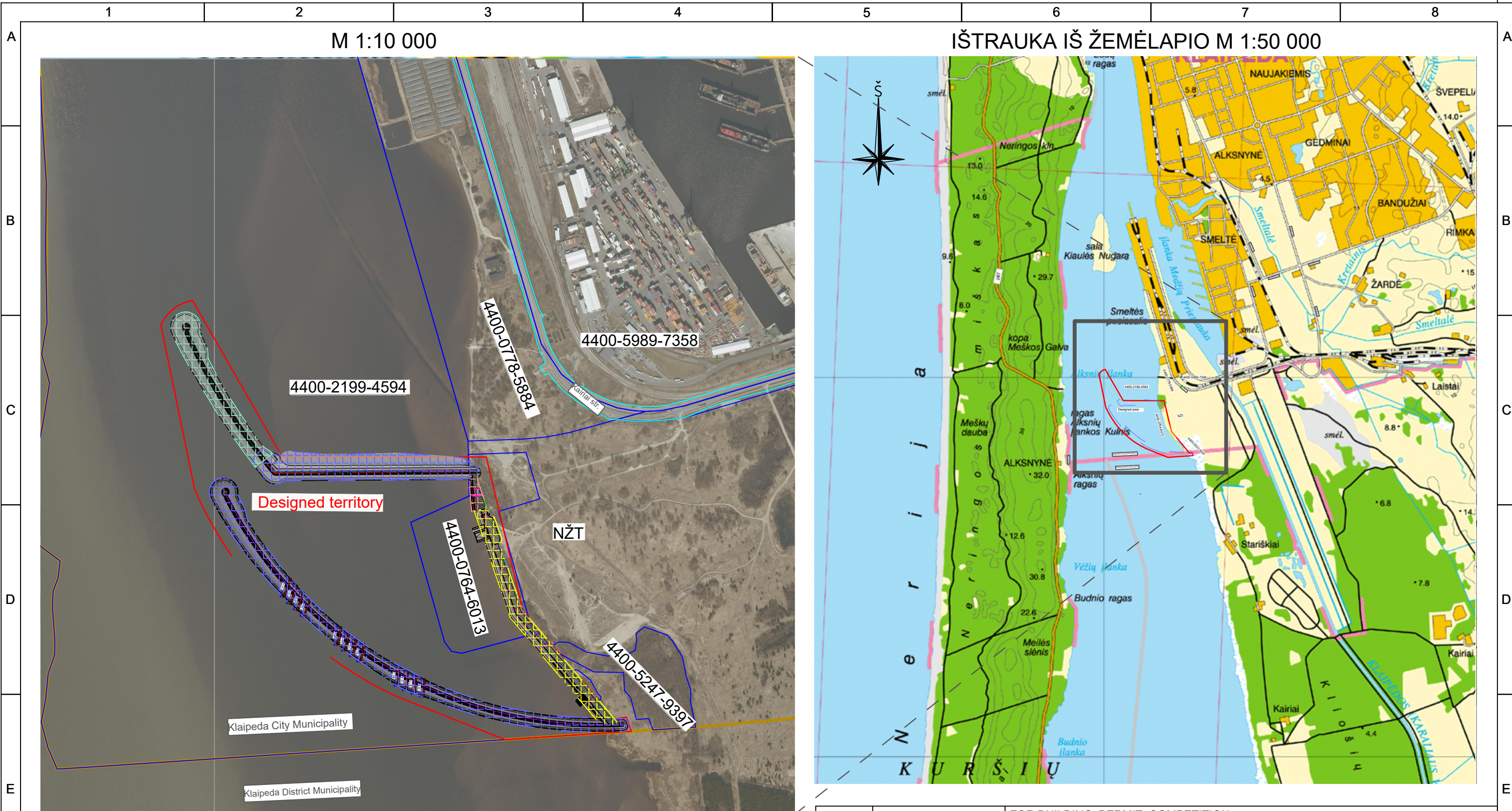

COMPANY	QUALIF. DOC. NO.	DUTIES	NAME SURNAME	SIGNATURE
UAB „Kelprojektas“				
	39928	Project manager	Rimantas Valančius	

22KNS1518

Document mark	No. of pages	Revision	Document title	Notes	Page No.
Text documents:					
8858-XX-TP-BD-01.02-BSŽ		0	File document composition chart		2
Brėžiniai:					
8858-XX-TP-BD-01.02-B-01		0	Site plan M 1:10000		3
8858-XX-TP-BD-01.02-B-02		0	Summary plan of engineering networks, M 1:2000		4



CONVENTIONAL SYMBOLS:

-  Registered engineering structure boundary (Kairių g.)
-  The boundaries of land use are formed by cadastral measurements
-  The planned territory of the southern port gates (Klaipėda city)
-  Construction stage I
-  Construction stage II
-  Construction stage III
-  Construction stage IV

0	2023-11	FOR BUILDING PERMIT, COMPETITION	
REVISION	DATE	REVISION STATUS, REASON FOR CHANGE (IF APPLICABLE)	
QUAL. CERT. DOC.NO.			NAME OF STRUCTURE PROJECT Construction project for transport communication structures (southern and northern dams, piers and quays) at Kairiai str. 17, Klaipėda
39928	BPM	R.Valančius	STRUCTURE NUMBER AND NAME All structures - No.XX
			DOCUMENT TITLE Site plan, M 1:10000
en	DEVELOPER AND/OR CLIENT AB KLAIPEDA STATE SEAPORT AUTHORITY J. Janonio str. 24, LT-92251 Klaipėda		DOCUMENT MARK 8858-XX-TP-BD-01.02.B-01
			SHEET SHEETS 1 1

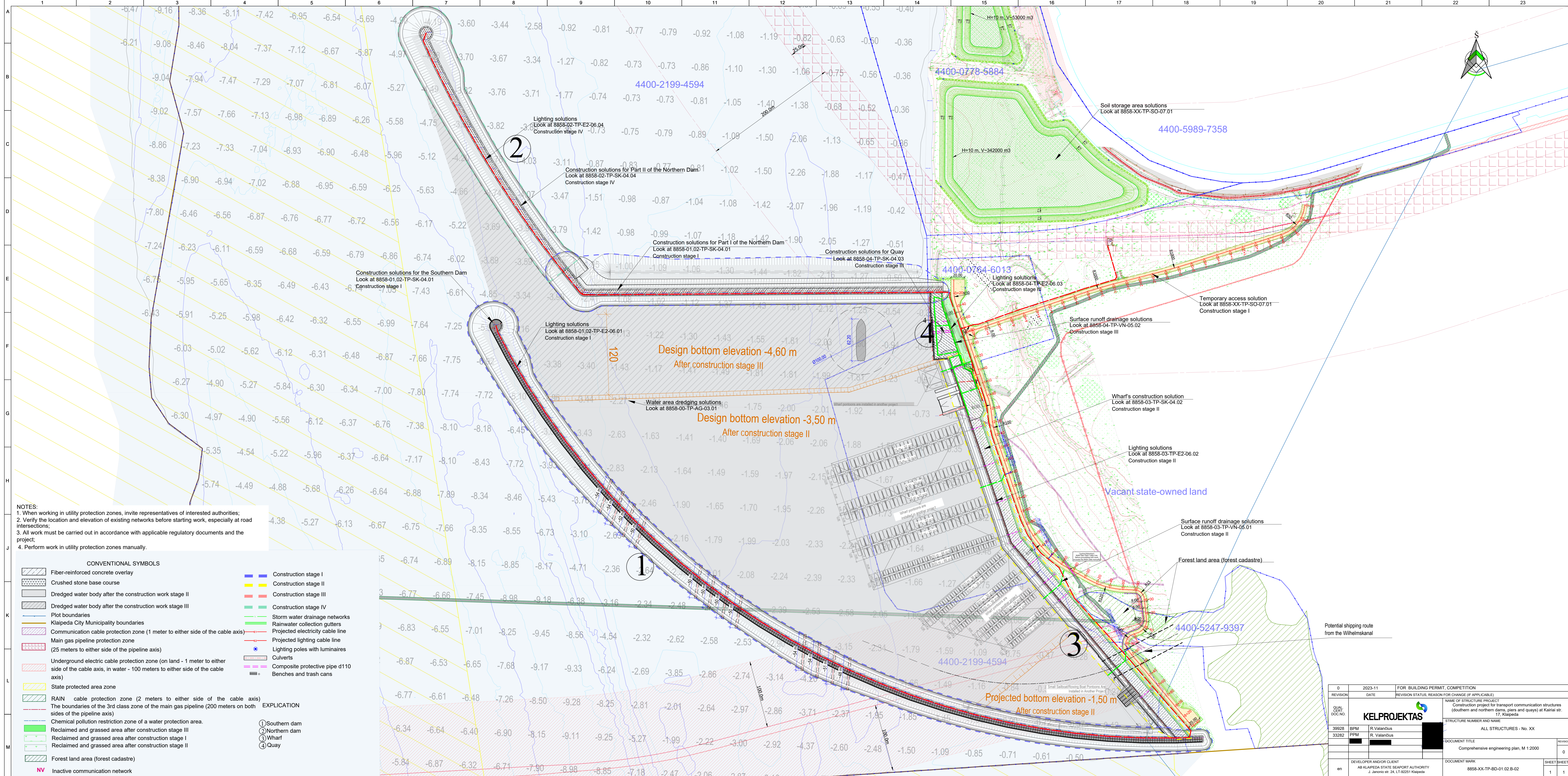

- NOTES:**
- When working in utility protection zones, invite representatives of interested authorities;
 - Verify the location and elevation of existing networks before starting work, especially at road intersections;
 - All work must be carried out in accordance with applicable regulatory documents and the project;
 - Perform work in utility protection zones manually.

CONVENTIONAL SYMBOLS

- Fiber-reinforced concrete overlay
- Crushed stone base course
- Dredged water body after the construction work stage II
- Dredged water body after the construction work stage III
- Plot boundaries
- Klaipeda City Municipality boundaries
- Storm water drainage networks
- Rainwater collection gutters
- Projected electricity cable line
- Main gas pipeline protection zone (25 meters to either side of the pipeline axis)
- Underground electric cable protection zone (on land - 1 meter to either side of the cable axis, in water - 100 meters to either side of the cable axis)
- State protected area zone
- RAIN cable protection zone (2 meters to either side of the cable axis)
- The boundaries of the 3rd class zone of the main gas pipeline (200 meters on both sides of the pipeline axis)
- Chemical pollution restriction zone of a water protection area.
- Reclaimed and grassed area after construction stage III
- Reclaimed and grassed area after construction stage I
- Reclaimed and grassed area after construction stage II
- Forest land area (forest cadastre)
- INV Inactive communication network

EXPLANATION

- Construction stage I
- Construction stage II
- Construction stage III
- Construction stage IV
- Storm water drainage networks
- Rainwater collection gutters
- Projected electricity cable line
- Projected lighting cable line
- Lighting poles with luminaires
- Culverts
- Composite protective pipe d110
- Benches and trash cans
- ① Southern dam
- ② Northern dam
- ③ Wharf
- ④ Quay

0	2023-11	FOR BUILDING PERMIT, COMPETITION
REVISION	DATE	REVISION STATUS, REASON FOR CHANGE (IF APPLICABLE)
QUAL. CERT. DOC. NO.	KELPROJEKTAS Construction project for transport communication structures (doughnuts and northern dams, piers and quays) at Kairiai str. 17, Klaipeda	
39928	BPM	R. Valandius
33282	PPM	R. Valandius
DEVELOPER AND/OR CLIENT		DOCUMENT MARK
AB KLAIPEDA STATE SEAPORT AUTHORITY J. Janonio str. 24, LT-92251 Klaipeda		8858-XX-TP-BD-01.02-B-02
STRUCTURE NUMBER AND NAME		SHEET SHEETS
ALL STRUCTURES - No. XX		1 / 1
DOCUMENT TITLE		REVISION
Comprehensive engineering plan, M 1:2000		0